

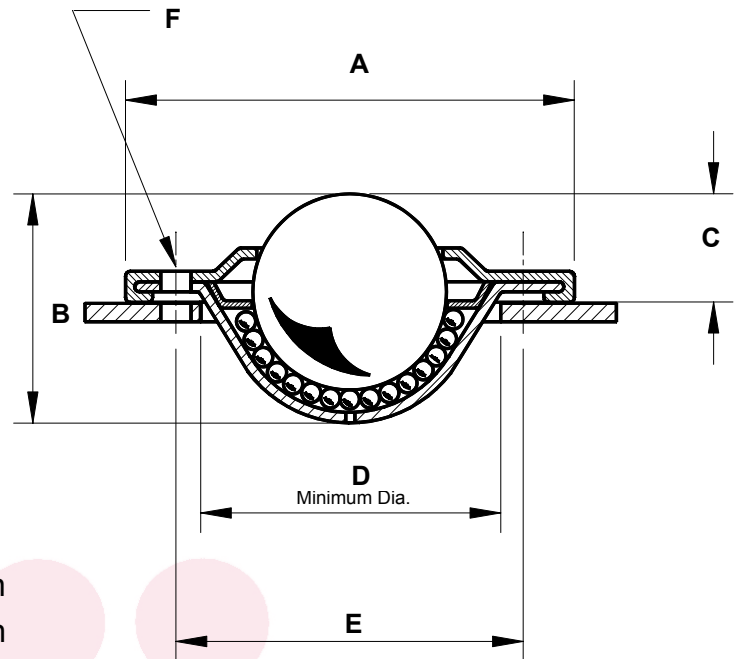

Ball Transfer Unit



Ball transfer unit consisting of a large solid high grade steel ball running on a number of smaller support balls housed in a hemispherical cup.

Supplied as standard with an integral felt seal and produced with a small self cleaning hole.

32mm ball unit is supplied in stainless steel with a grade 420 main ball. Fixing is either 2 or 3 hole.

Stainless steel units are used predominantly in the air cargo handling/ground support industry and are supplied without integral felt seals.

REFERENCE	MATERIAL & FINISH	DIMENSIONS						STATIC LOAD Kg.
		A mm	B mm	C mm	D mm	E mm	F mm	
BTB25	MILD STEEL ZINC PLATED	74	29.8	15.2	40	56	5.1	60
BTB25SS	STAINLESS STEEL	74	29.8	15.2	40	56	5.1	60
BTB32SS	STAINLESS STEEL	73.8	37.2	16.65	46	58.7	5.1	125